

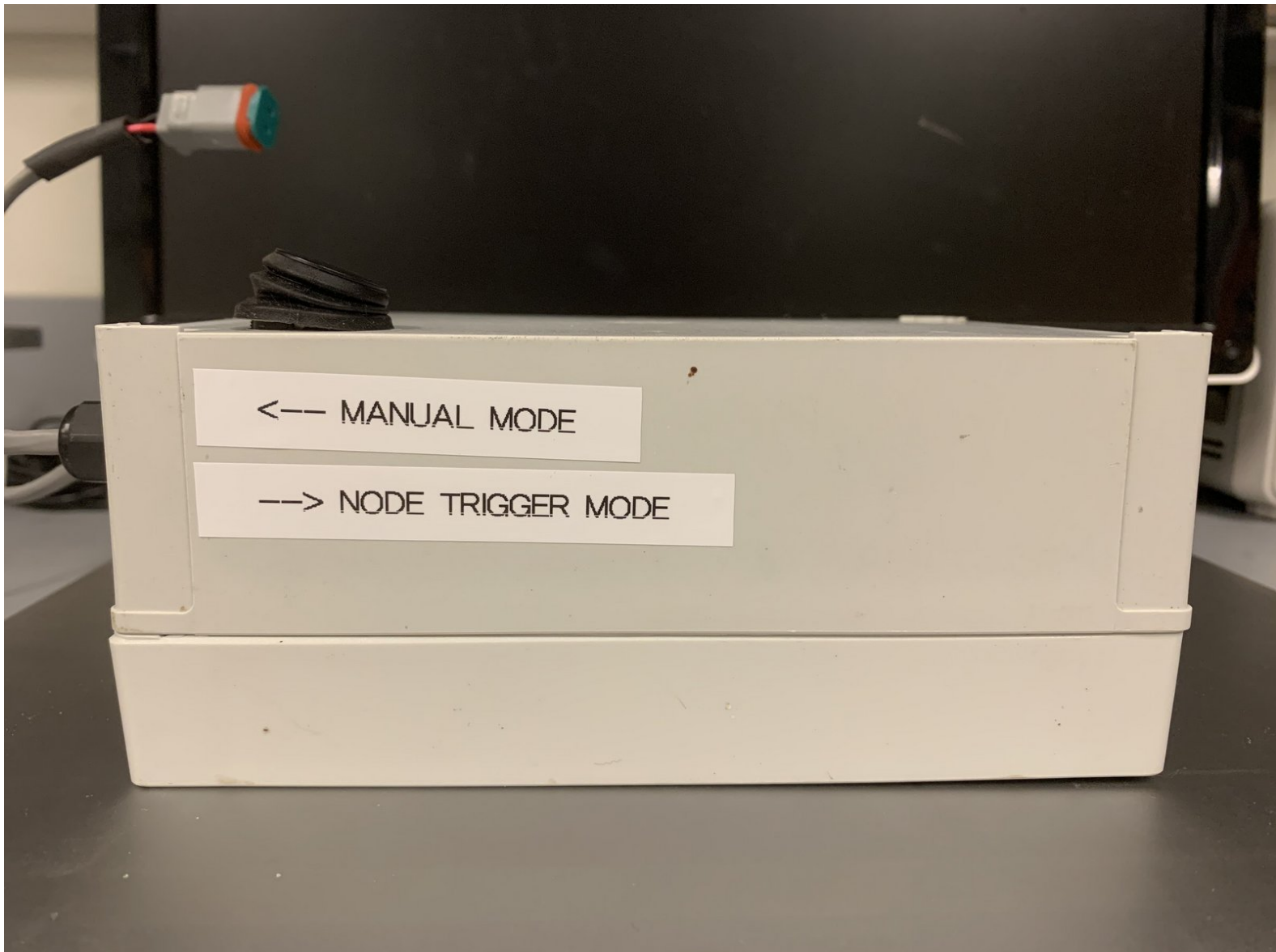

# Autosampler Reset for Node Triggered Sampling (For Old & New Versions)

How to reset an ISCO autosampler once bottles have been collected.

Written By: Brandon Wong



## Step 1 — Switch to manual mode

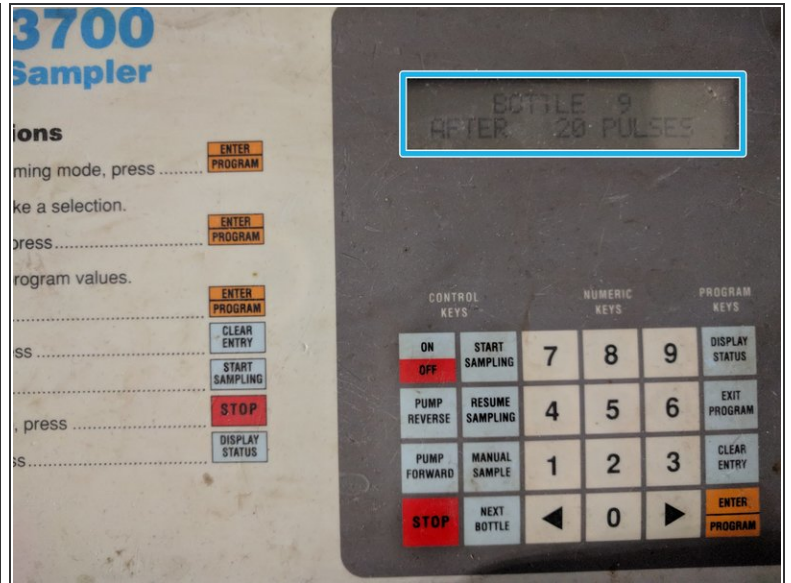
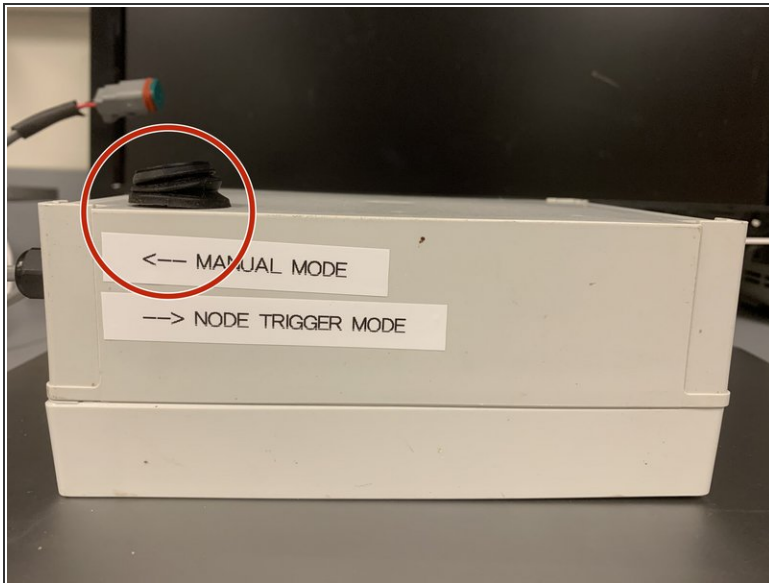

- To enable manual mode, flip the switch to "Manual Mode"
- LCD screen will turn on

## Step 2 — Restart the sampling program

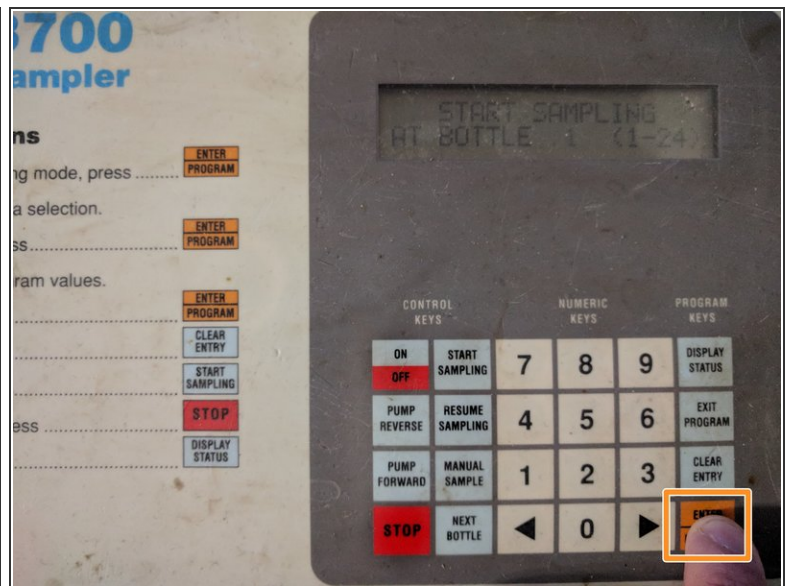

- Press On then press Start Sampling
- Press Enter



### Step 3 — Select bottle

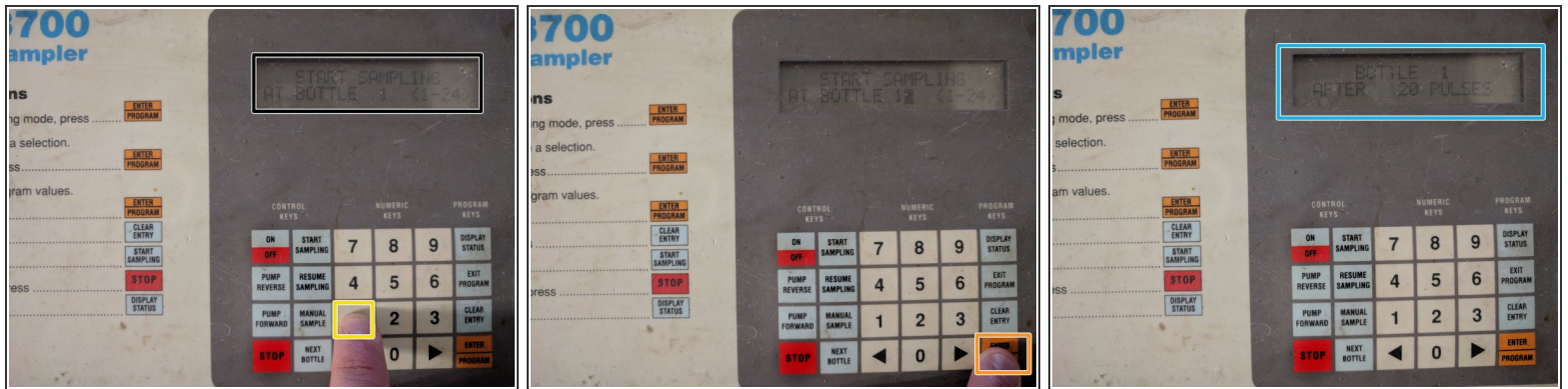

- Press the number of the bottle you want to sample on
- Press Enter
- LCD should now show which bottle it will take a sample in

### Step 4 — Switch to autonomous mode

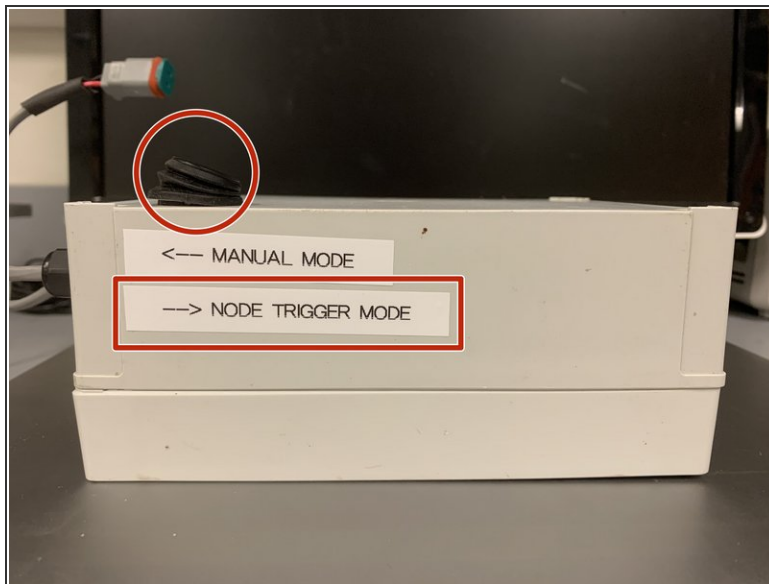

- To enable autonomous mode, flip switch to "Node Trigger Mode"
  - LCD should turn off
- ⚠ If the autosampler is to be remotely triggered, avoid using the ON/OFF button to power off the sampler.

Now the sampler is ready to be triggered remotely by an open-storm sensor node.