



Shark DuoClean Powered Lift-Away Speed External Pieces Replacement

This guide will show you how to detach all of the vacuum features in order to allow access for further replacements.

Written By: Grace



INTRODUCTION

This is not a replacement guide. Use this to make your Shark DuoClean Powered Lift-Away Speed replacements more manageable. No special tools or skills are required.

Step 1 — External Pieces



- Press the Hose Release button and pull back to detach the hose.

Step 2

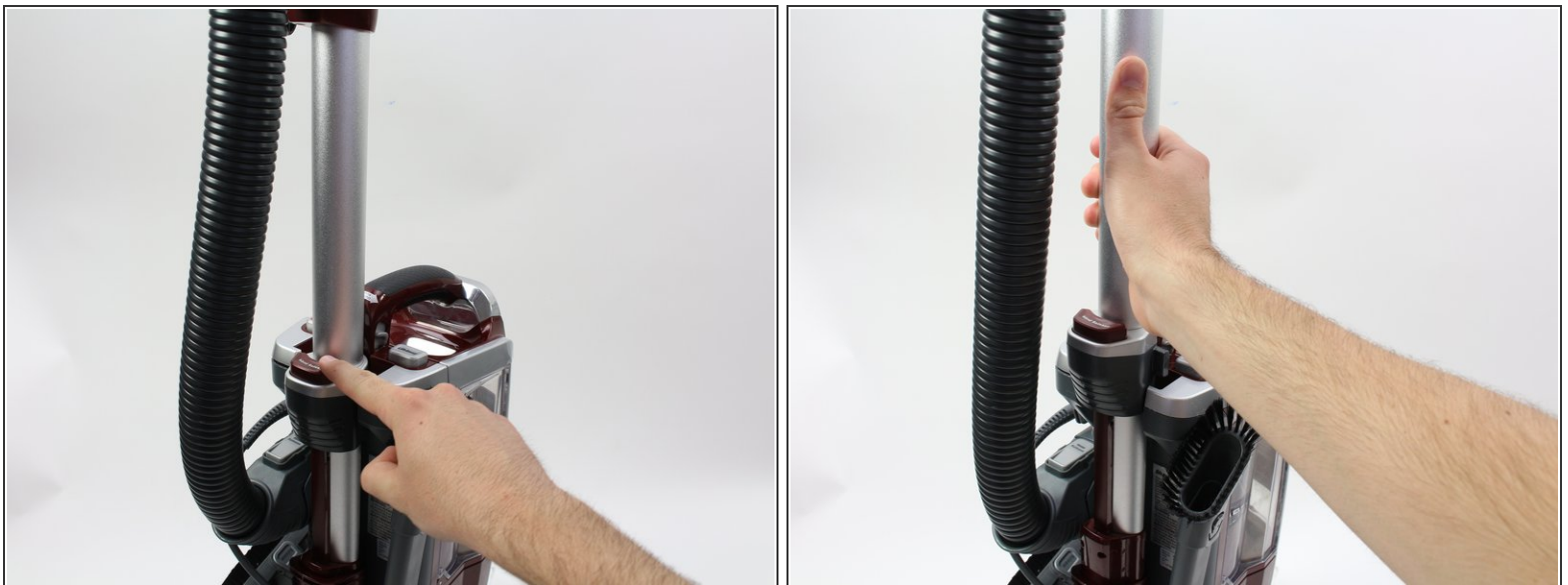

- Press the Wand Release button and pull up on the metal tube to remove the entire hose.

Step 3



- Press the Lift Away button and pull up on the handle to separate the top of the vacuum from the bottom.

Step 4



- Pull up on the extra brush pieces to remove them from the vacuum.

To reassemble your device, follow these instructions in reverse order.