



# Newport e500 Flow Sensor Cover Disassembly

This guide shows how to disassemble the flow sensor cover in the Newport e500 ventilator.

Written By: Jared McMullen

## *Flow Sensor Cover*

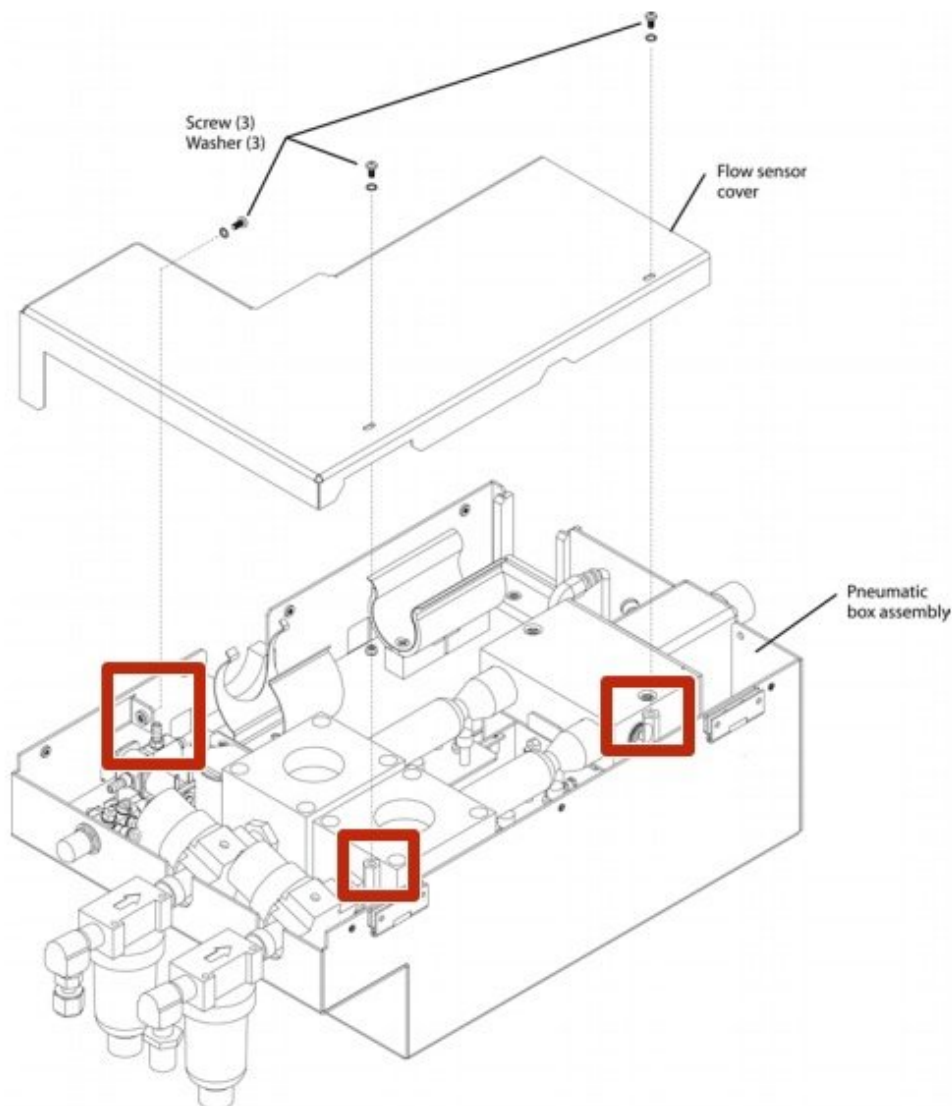

---

## INTRODUCTION

This guide deals with an important prerequisite, the removal of the flow sensor. Once removed, many more components can be accessed on the top of the e500 ventilator. This step is very simple, but must be done carefully as there are a lot of exposed parts in the process. For more information refer to page 43 of the service manual.

---

### TOOLS:

- [Phillips #0 Screwdriver](#) (1)

## Step 1 — Newport e500 Flow Sensor Cover Disassembly

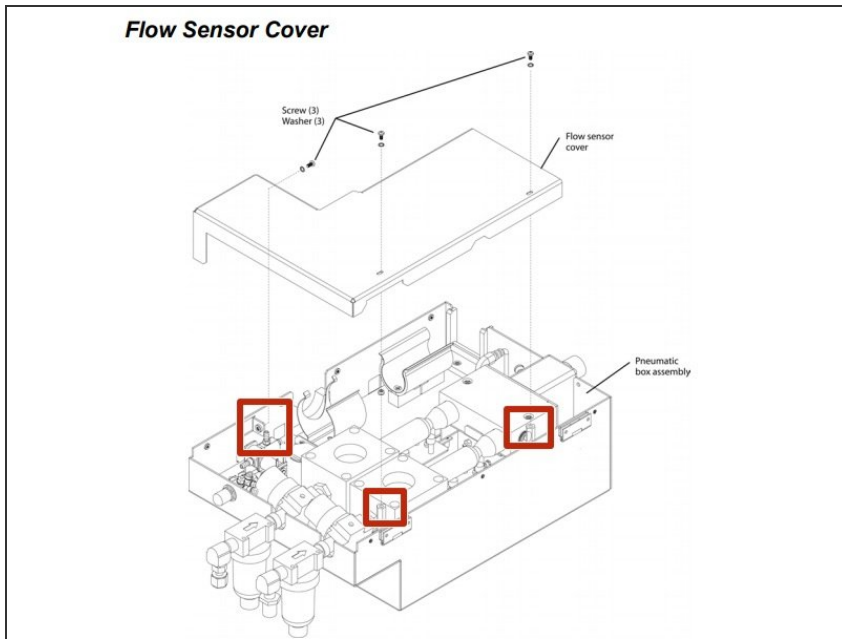

- Remove the three screws and washers that secure the flow sensor cover to the pneumatic box assembly. Retain the hardware for re-assembly.

## Step 2

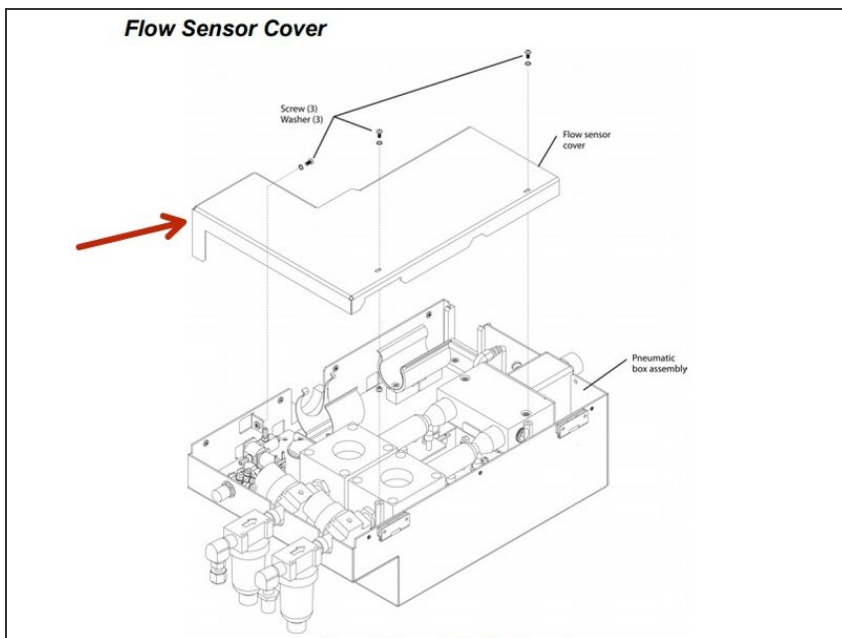

- Remove the flow sensor cover.

To reassemble your device, follow these instructions in reverse order.