



How to use the 2010-2017 Suzuki Swift emergency jack

This guide will show how to use the emergency jack from a 2010-2017 Suzuki Swift.

Written By: knipwim



INTRODUCTION

The included emergency jack should only be used for changing wheels, and is rated for lifting 950 kg.

Step 1 — retrieve jack

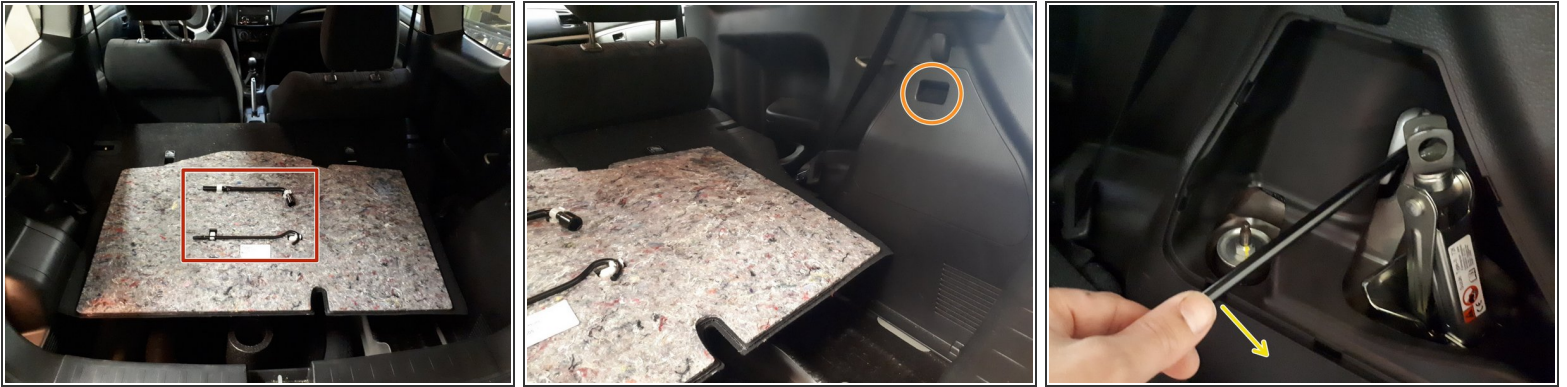

- Open the boot, turn over the floor and retrieve the jack crank and the tire iron.
- Open the compartment where the jack is located.
- Using the jack crank, turn the jack axle counter clockwise to unsecure it from the compartment and pull it out.

Step 2 — position jack



- There are 4 u-shaped jack supports underneath the car, located next to each wheel.
- Turn the jack axle by hand until the support slot of the jack can be placed on the support.

⚠ Only use the emergency jack on the jack supports.

⚠ Make sure the car is on a hard level surface.

⚠ Make sure the jack has at least 51mm load free displacement from its starting position.

Step 3 — jack up the car

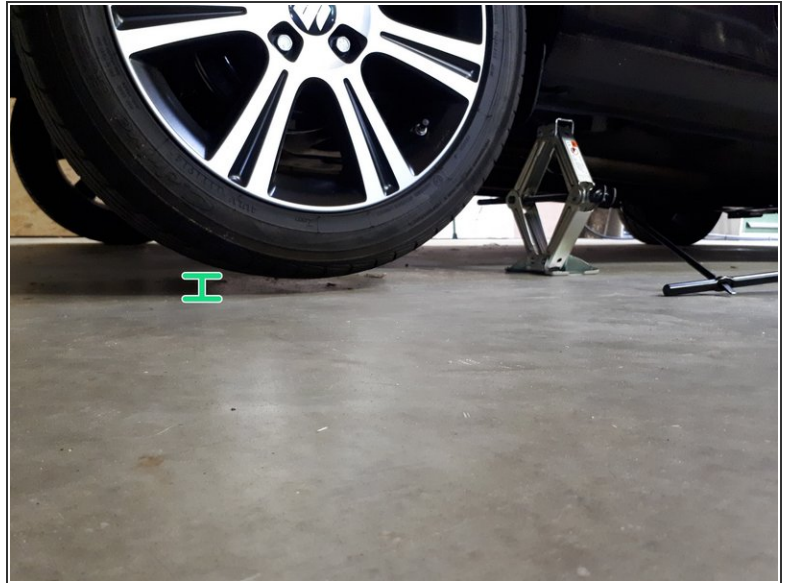
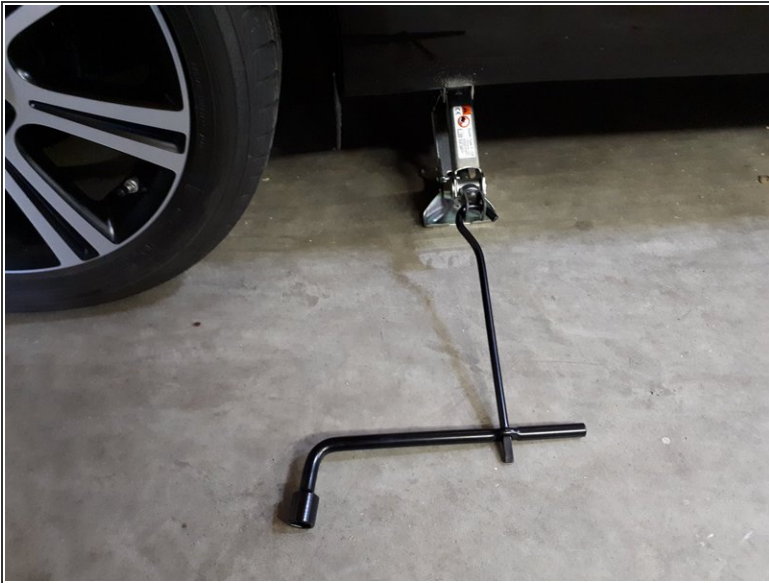

- ⚠ Make sure the handbrake is on, and the gear is in **reverse** for manual or **park** for an automatic transmission car.
- ⚠ Make sure no people are in the car when the car is jacked up.
 - Place the jack crank on the jack axle, and using the tire iron, turn clockwise.
 - Stop cranking when the wheel is high enough from the ground to be replaced.
- ⚠ Do not go underneath the car while it is jacked up with the emergency jack.

Follow these instructions in reverse order, to lower the car and put the tools back.