



# Reset Bluetooth Module or Factory Reset All Connected Apple Devices

How to enter Bluetooth Debug Menu and Factory Reset Apple Devices

Written By: ZFix



## INTRODUCTION

[video: <https://youtu.be/c0m85MSKp2Q>]

## Step 1 — Reset Bluetooth Module or Factory Reset All Connected Apple Devices

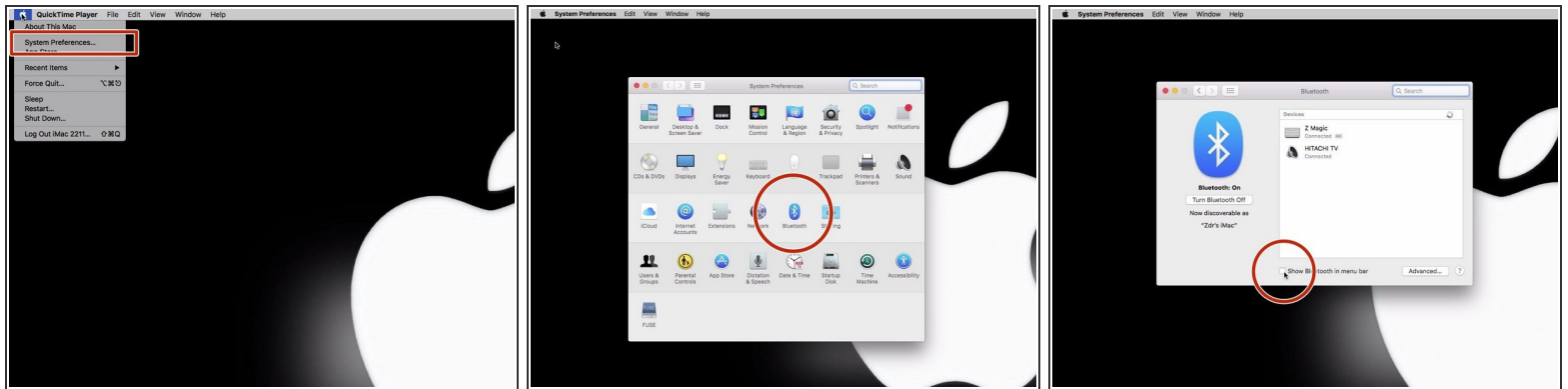

- First enable the Bluetooth Icon in the Menu Bar
- Click the Launchpad icon in the Dock, and then navigate to "System Preferences" - "Bluetooth".
- Click the checkbox next to "Show Bluetooth in Menu Bar" to enable it.

## Step 2

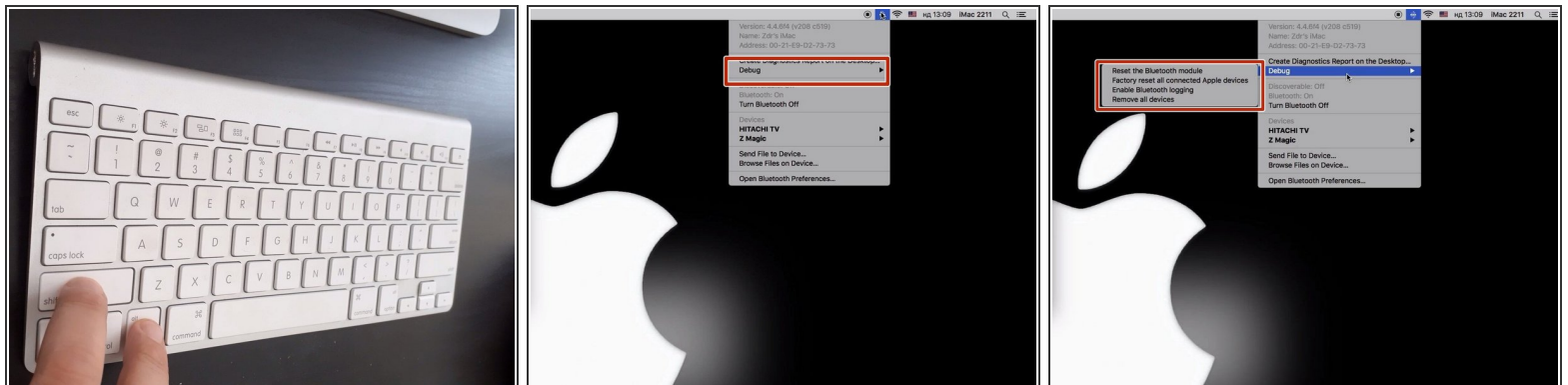

- Press and hold the Shift + Option keys on your Mac's keyboard and click the Bluetooth symbol in the top-right corner of the macOS menu bar.
- Locate the revealed Debug submenu and hover your mouse cursor over it.
- If you have problem with a connected Bluetooth device you can reset the Bluetooth module entirely from the Debug menu. This will wipe the Bluetooth configuration, reset the Bluetooth hardware, and disconnect any connected Bluetooth devices.
- If you want to fix a problem with connected Apple device then try the second menu. It works only the device is connected an only for Apple devices!

This document was generated on 2021-03-26 09:51:35 AM (MST).

To reassemble your device, follow these instructions in reverse order.