



# Reattaching the GEN 2 Wheelchair Foot Support

## Support

Occasionally the foot supports on the wheelchair will fall off because of normal wear over time. They are usually not broken and just need to be reconnected.

Written By: Kali Slaughter



---

## INTRODUCTION

This guide will show how to reconnect the foot support to the wheelchair after it has fallen off.

---

### TOOLS:

- [10mm Wrench](#) (1)
-

## Step 1 — Foot Support

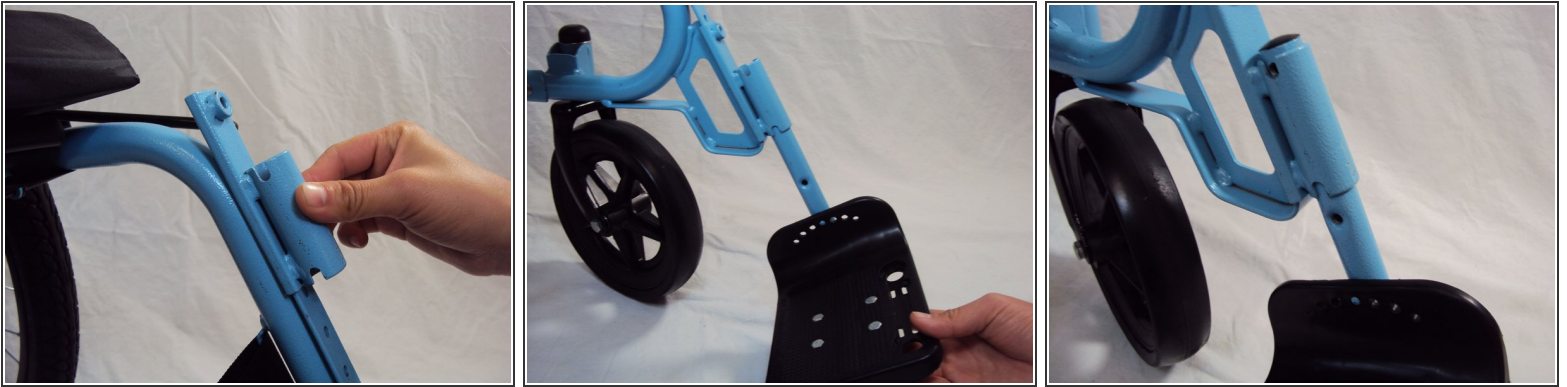

- Slide the footrest sockets down as shown and use a 10 mm wrench to tighten the bolts at the desired height.

## Step 2



- Screw in the bolt to the top socket to secure the height of the footrest.

### Step 3

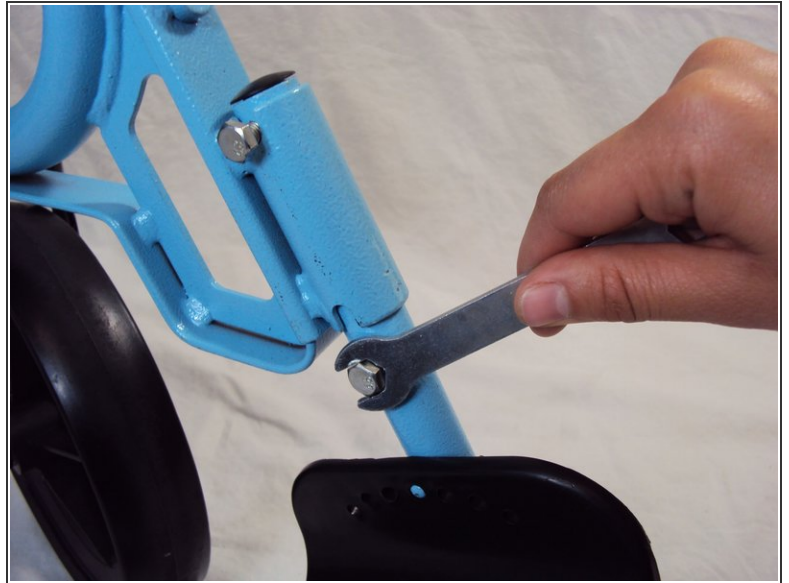

- Screw in the bolt attaching the footrest to the frame.
- Screw in the lower bolt to the footrest.

Check that the footrest is at the desired height. If the footrest is still uncomfortable start the guide over again from step 1 using a different height to tighten bolts.

This document was last generated on 2019-07-15 11:19:50 AM.