



PSP 1000 Battery Replacement

Written By: Stephen Kazim



INTRODUCTION

This guide will show how to replace the Sony PSP-1000 battery.

TOOLS:

- [iFixit Opening Tools](#) (1)
-

Step 1 — Battery



- Turn the PSP over so its back is facing you.

Step 2

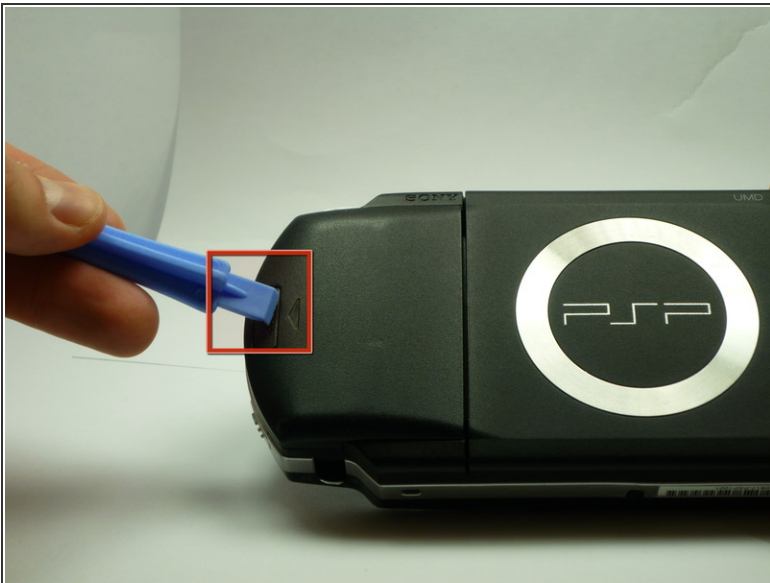

- Locate the battery casing button on the rear-left side of the PSP.
- Press down the button and remove the battery cover.

Step 3



- Using your finger, remove the battery upwards from the system as shown.

To reassemble your device, follow these instructions in reverse order.

This document was last generated on 2017-06-18 04:02:15 AM.