



Reinstalling Nokero Shavano N220 Handle

How to reapply your handle on your Nokero Shavano N220.

Written By: Erica Hill



INTRODUCTION

The handle of your light may come off, on occasion. Never fear, this guide will show you how to put it back on.

Step 1 — Reinstalling Nokero Shavano N220 Handle



- With the handle in one hand and your Nokero Shavano N220 in the other, insert one side of the handle into the hole.

Step 2

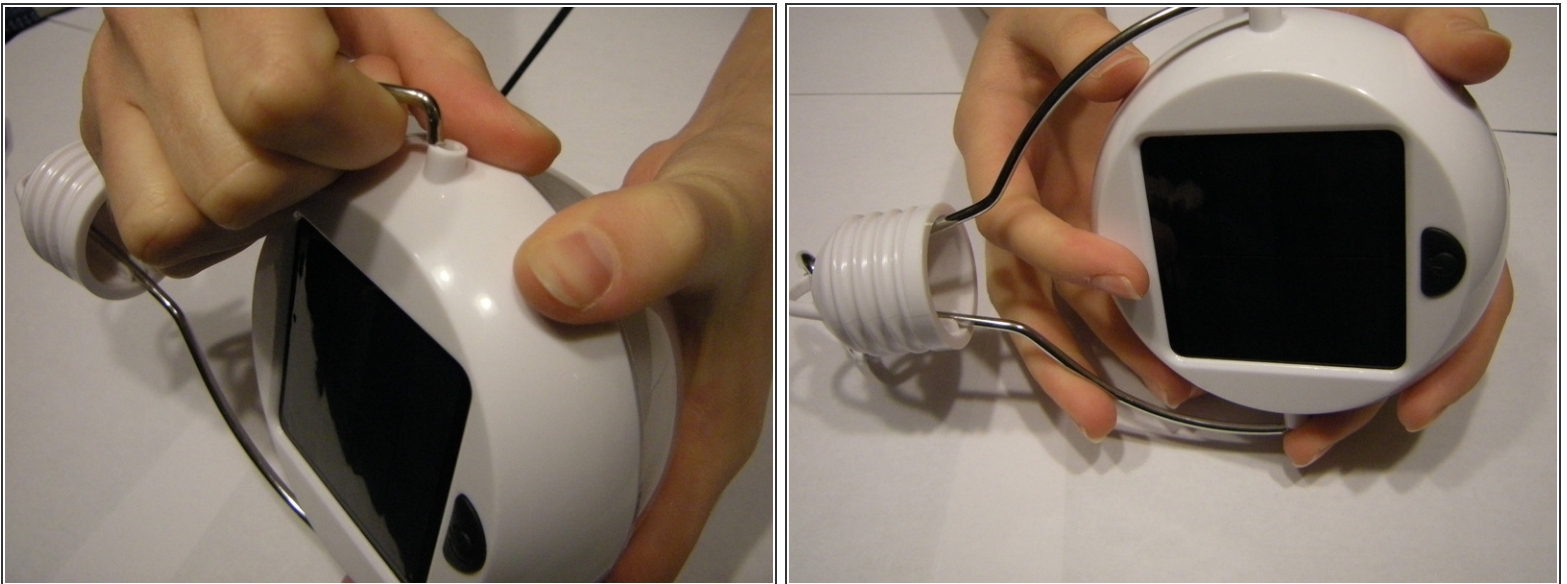

- On the other side, firmly pull outwards on the handle until you can slide it into place.

To reassemble your device, follow these instructions in reverse order.

This document was last generated on 2017-06-17 06:24:34 PM.