



# Lezyne CNC Dirt Floor Drive Gauge Replacement

Replace the pressure gauge in your CNC floor drive pump.

Written By: iRobot



## INTRODUCTION

Replace the pressure gauge in your CNC floor drive pump if the gauge appears to be inaccurate, is malfunctioning or has stopped working all together.

### TOOLS:

- [Screwdriver](#) (1)  
Flat head
- [Vice Grips](#) (1)

### PARTS:

- [Loctite](#) (1)
- [CNC Dirt Floor Pump](#) (1)

## Step 1 — Removing the Gauge Cover



- Using a flat head screwdriver, pry up an edge of the gauge cover.
- Remove the gauge cover.

## Step 2 — Removing the Gauge Face Plate and Internals

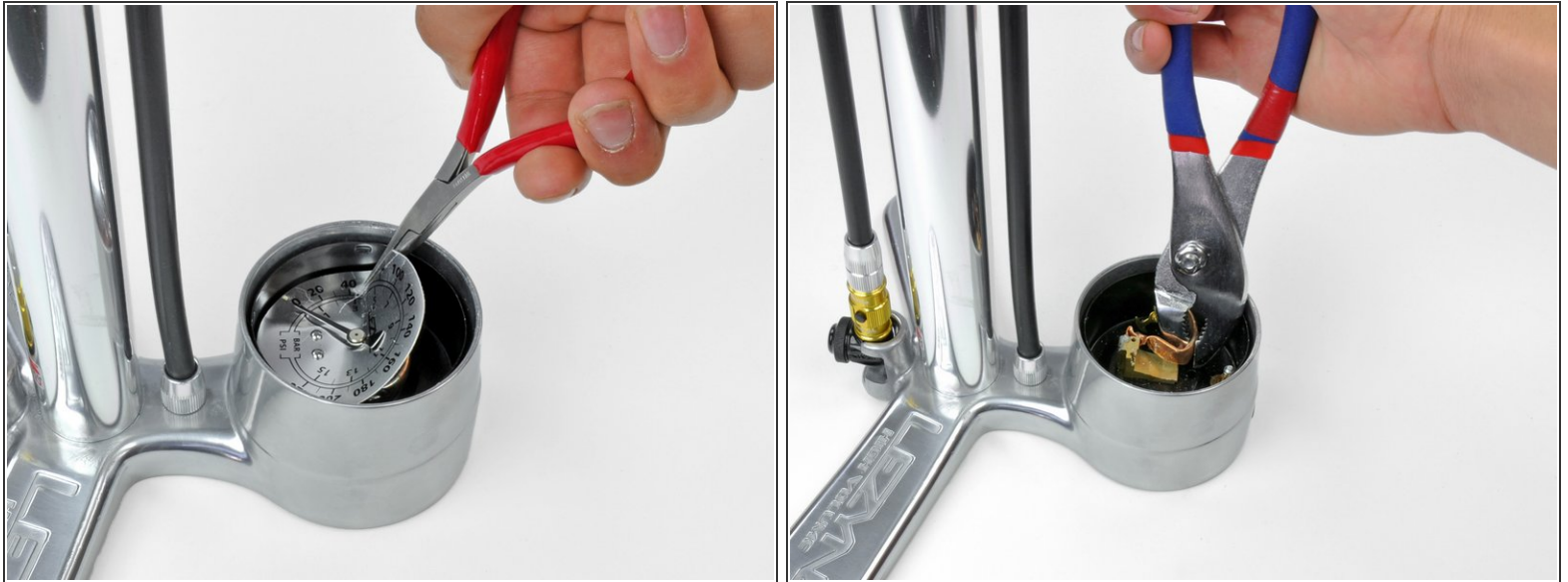

- i** No parts from the old gauge will be re-used, so there is no need to attempt to preserve the parts. However, be careful not to damage the gauge housing.
- Pry up a corner of the gauge face plate.
  - Use pliers to pull off the gauge face plate.
    - !** Be careful when prying off the face plate, as the edges are sharp.
  - Use pliers to remove the internal gauge mechanics.

### Step 3 — Removing the Old Gauge



- Using pliers, grip the exposed brass piece and unthread the gauge by rotating the gauge counter-clockwise.
- Pull the gauge out of its housing.

### Step 4 — Replacing the Gauge O-rings



- Remove the O-ring that is at the bottom of the threaded hole that the gauge threaded into.
- Place a new O-ring into the hole.

## Step 5 — Applying Threadlocker



- Apply medium-strength Loctite (green, 290) to the threads of the new gauge.

## Step 6 — Installing the New Gauge



- Thread the new gauge into the floor pump by turning it clockwise in its housing.
- Thread the gauge until it is snug and the BAR/psi markings are aligned with the pump body.
  - ⓘ Gauge performance will not be affected by its position, so long as it is snug.
- Allow at least 30 minutes for the thread locker to set.
- Test pump to its highest rated pressure and listen for leaks. If you can hear leaks from the gauge, tighten it.

This document was last generated on 2019-07-10 12:39:33 AM.