

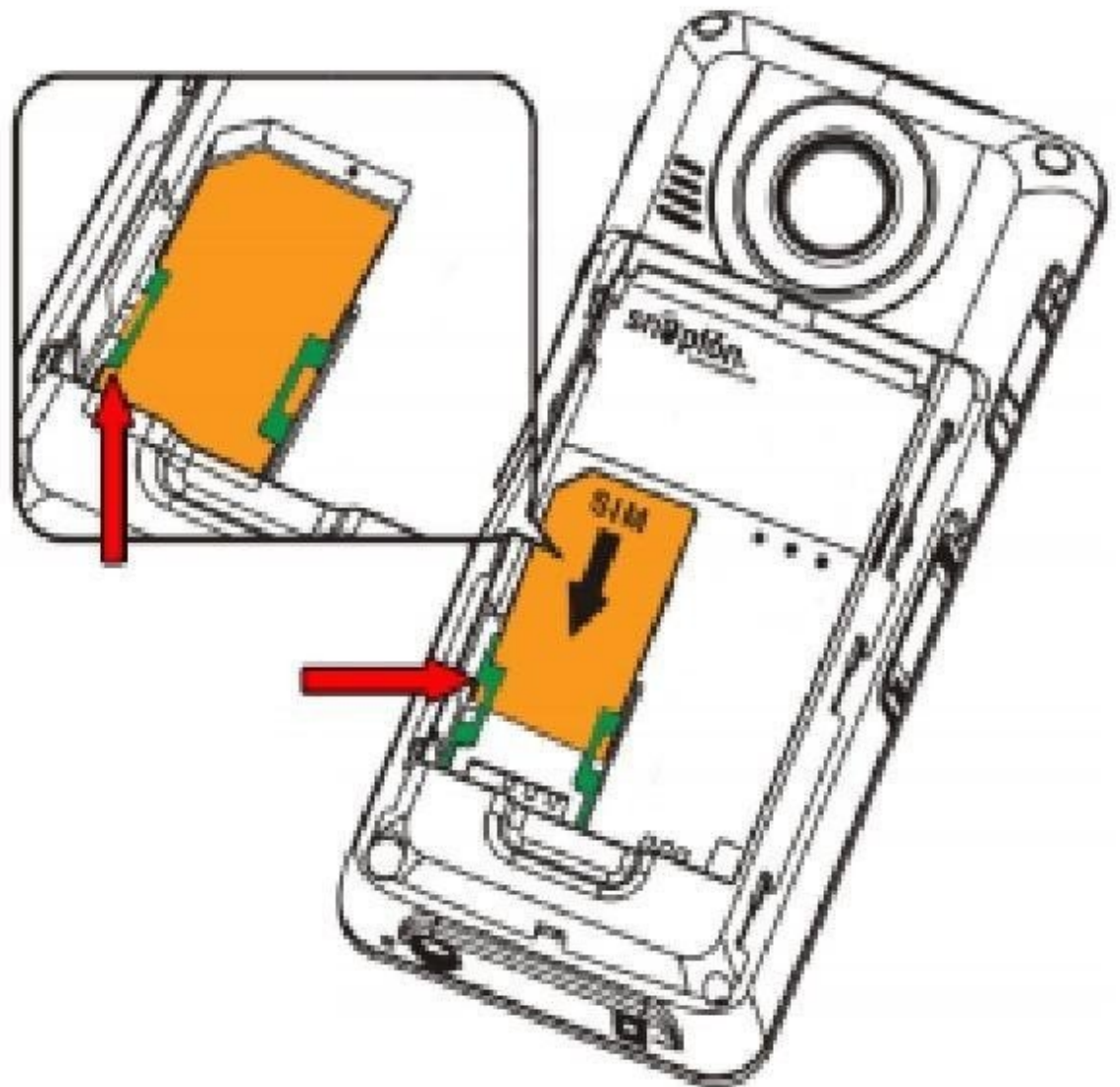

Snapfon ez One SIM Card Replacement

This guide will help the user access/remove the SIM card.

Written By: John Bender



INTRODUCTION

The SIM card is a removable storage component inside of the phone. The card stores phone numbers and other important information to the user.

TOOLS:

- [iFixit Opening Tools](#) (1)
 - [Tweezers](#) (1)
-

Step 1 — Remove the battery cover



- Make sure the phone is turned off by pressing the power off button to ensure no data is lost.
- Remove the back battery cover by sliding it downward and pushing simultaneously.
- ⓘ Picture rights belong to Snapfon®. Picture is used for educational purposes only. No copyright infringement intended.

Step 2 — Remove the battery

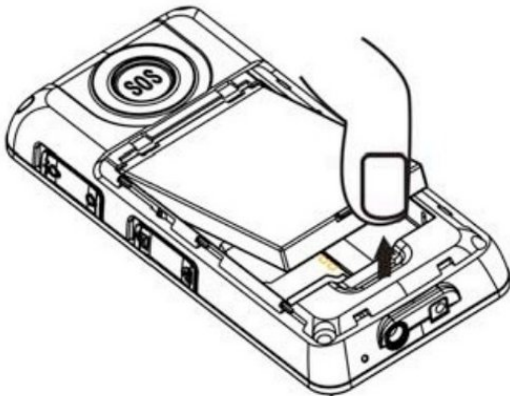

- Using either your thumb or the opening tools, remove the battery by prying the battery out in the direction of the arrow.
- ⓘ If removing battery is for the replacement of a new battery make sure to properly dispose of the old battery at a recycling center.
- ⓘ Picture rights belong to Snapfon®. Picture is used for educational purposes only. No copyright infringement intended.

Step 3 — SIM Card

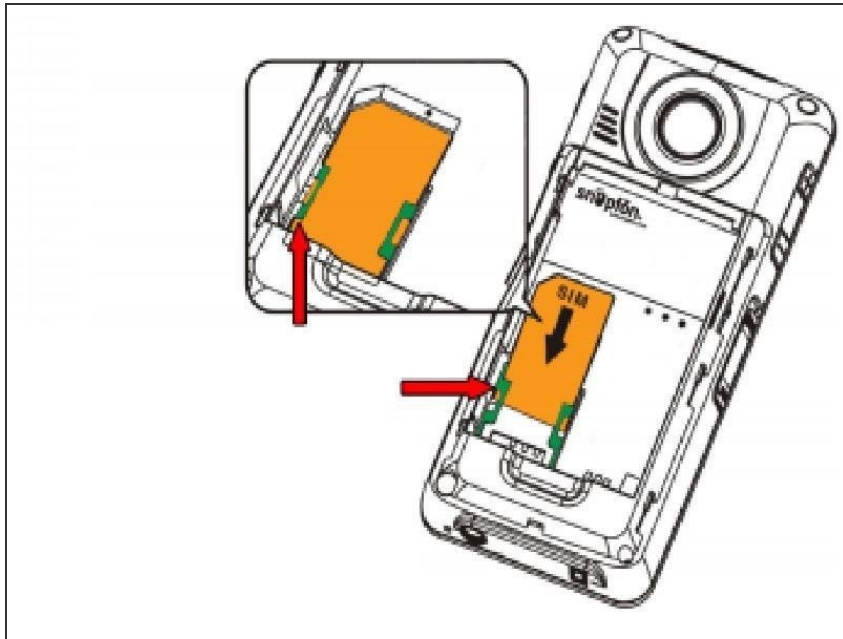

- Use the tweezers, if needed, to grasp the SIM card for removal. Apply a slight pulling tension and remove it from under the tabs as shown.
- ⓘ Picture rights belong to Snapfon®. Picture is used for educational purposes only. No copyright infringement intended.

To reinsert the SIM card or a new SIM card, position the card in the same orientation seen in the figure with the brass connections facing the phone while using thumb to apply a slight force until the card rests inside of the recessed holder. Make sure the brass contacts of the card and phone connect. Then follow the steps in reverse order to reassemble phone.

This document was last generated on 2019-07-18 12:44:15 AM.