



# Opening the Computer (Early 2008)

First step in most Mac Pro (Early 2008) guides. Opening the Computer.

Written By: Joshua Byrne



## INTRODUCTION

First step in most Mac Pro (Early 2008) guides. Opening the Computer.

---

### TOOLS:

- [Anti-Static Wrist Strap](#) (1)
-

## Step 1 — Opening the Computer (Early 2008)

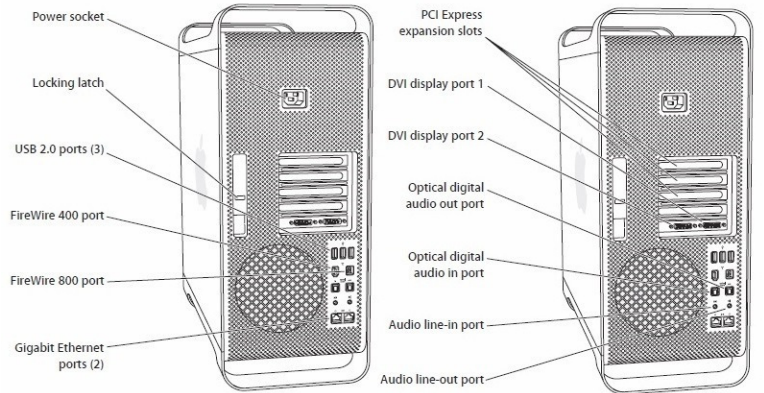

- Shut down the computer.

**⚠ Warning:** Always shut down the computer before opening it to avoid damaging its internal components or the components you are installing. Do not open the computer or attempt to install items inside it while it is on.

- Wait 5 to 10 minutes to allow the computer's internal components to cool.

**⚠ Warning:** After you shut down the system, the internal components can be very hot. You must let the computer cool down before continuing.

- Unplug all external cables from the computer except the power cord.
- Touch the metal PCI access covers on the back of the computer to discharge any static electricity from your body.
- Unplug the power cord.
- Put on an ESD wrist strap.

## Step 2

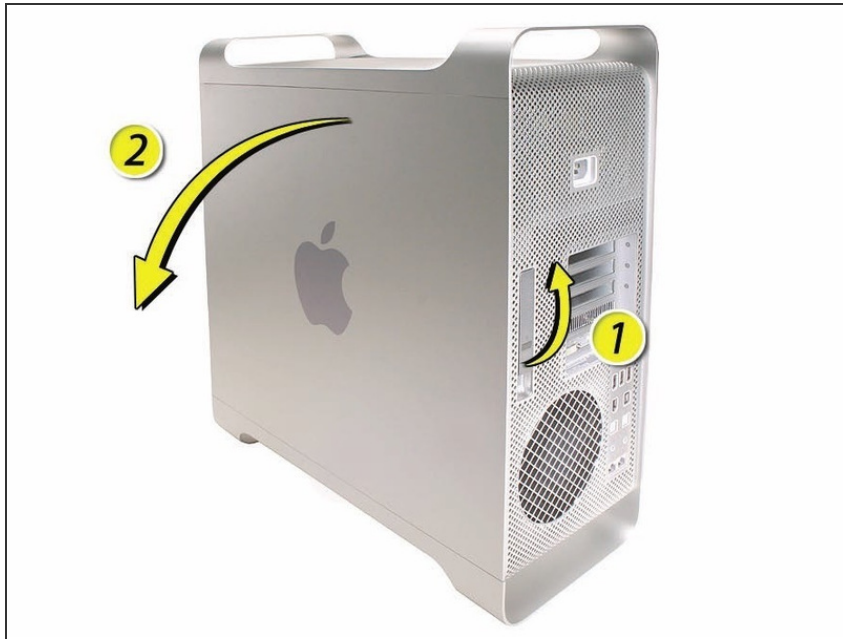

- 1) Hold the side access panel and lift the latch on the back of the computer.
- ⚠ Warning: The edges of the access panel and the enclosure can be sharp. Be very careful when handling them.
- 2) Remove the access panel and place it on a flat surface covered by a soft, clean cloth.
- ⓘ Replacement Note: Make sure the latch is in the up position before replacing the access panel. If the latch is down, the access panel will not seat correctly in the enclosure.

To reassemble your device, follow these instructions in reverse order.

This document was last generated on 2017-06-16 07:39:45 PM.