



# BMW M-Colored LED Front Kidney Grille Installation

This is a quick guide to show you how to swap out the BMW front kidney grille for a new M-Colored LED Stripe kidney grille.

Written By: Eric Wu



## INTRODUCTION

Did you know that you don't have to stick with the basic BMW kidney grille? You can give your BMW a whole new, high quality M-colored LED kidney grille to pay tribute to the iconic stripes. This LED grille kit is compatible with E46, E36, E60, E64, E65, E90, E92, F10, F30, F25, F32, etc.



### PARTS:

- [BMW M-Colored LED Illuminated Grille](#) (1)
- [BMW M-Stripe LED Kidney Grille](#) (1)

## Step 1 — Prep Work

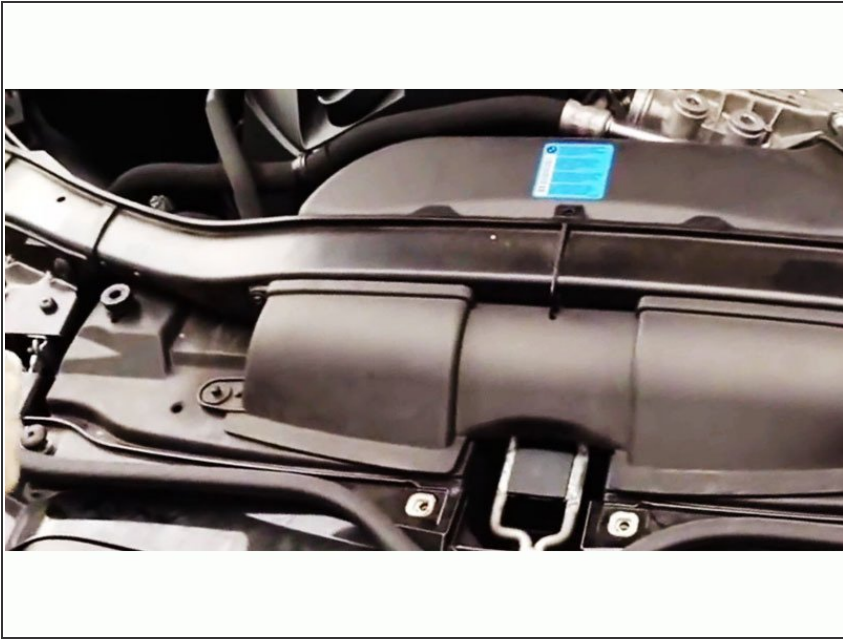

- You will need to remove a couple of bolts on the front bumper before you can start removing the BMW factory kidney grille.

## Step 2 — Taking out the factory kidney grille

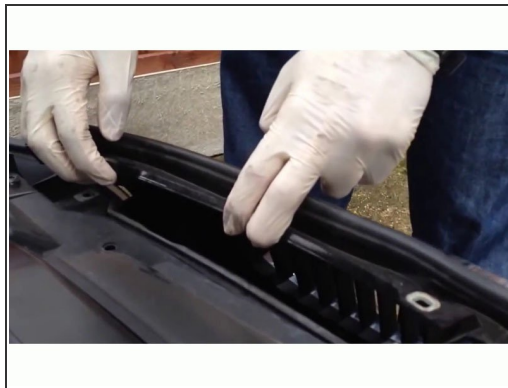
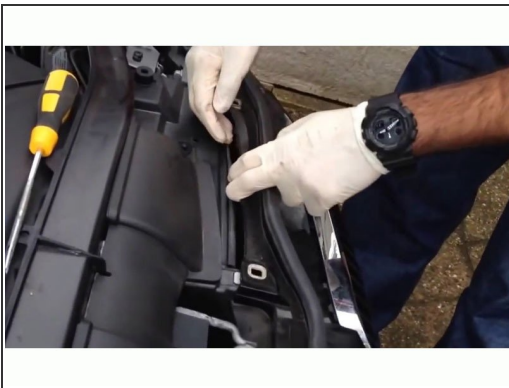

- When you have enough clearance space, you can wedge your hand in between the gap to pop out the stock kidney grille.
- Keep maneuvering your hand in the space to ease the stock grille out.

### Step 3 — Watch out for the clips



- Detach the stock kidney grille from the clips holding it onto the BMW front bumper.

### Step 4 — Starting the swap

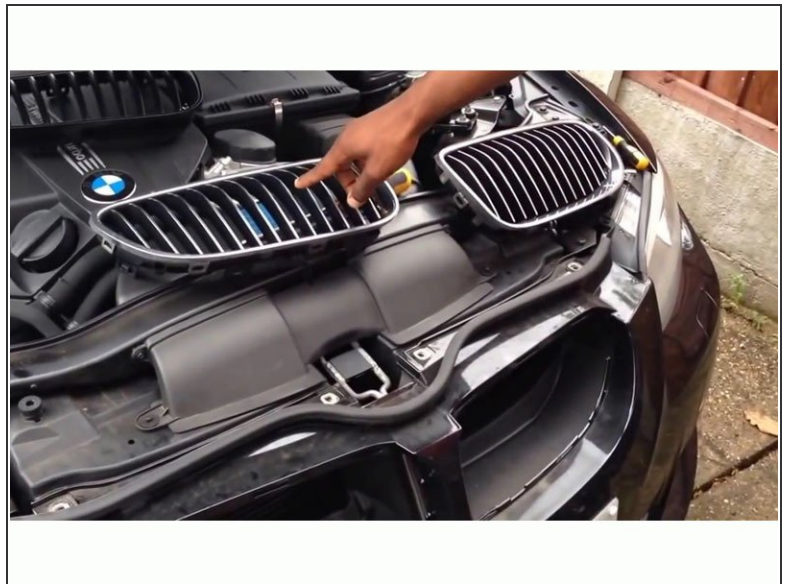
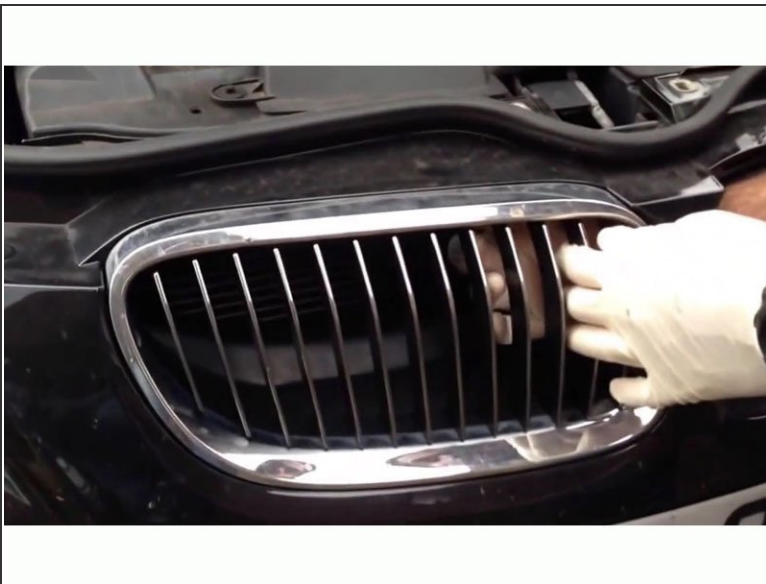

- Pull out the factory kidney grille.

## Step 5 — Putting in the new LED kidney grille

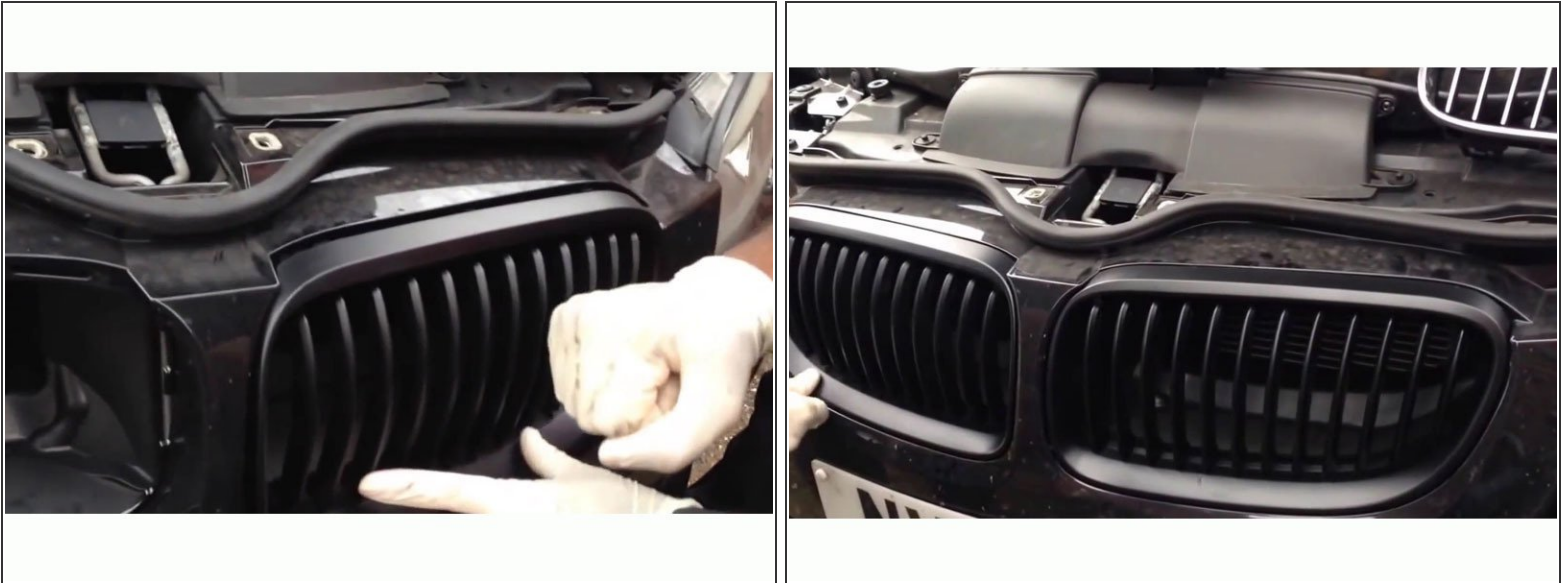

- Use your hand to apply a bit of pressure to pop the new LED M-stripe kidney grille in place
- Secure the new LED grille onto the clips.
- Note: the M-Colored LED stripe is only on the right grille assembly.
- Tap the wire to the ACC or other 12V power source.
- Repeat on the other side.

## Step 6 — Put everything back



- Put the bolts back into the BMW front bumper.
- Enjoy your new M-Colored BMW LED Illuminated kidney grille.

You can see that you didn't need to be an advanced car installer to attempt this. This makes the installation great for beginners as well as seasoned car fans alike.