



Logitech M215 Battery Replacement

Replace your battery the event that your Logitech M215 wireless mouse runs out of power, or you need to access components behind the battery.

Written By: Hannah Pate



INTRODUCTION

For this replacement you do not need any tools, however a prying tool may make the replacement easier.

Make sure that the mouse is turned off before replacing the battery. This will reduce the chance of damaging internal components with a surge of power from the new battery.

TOOLS:

- [iFixit Opening Picks set of 6](#) (1)
- [Plastic Cards](#) (1)

Optional

PARTS:

- [AA Battery](#) (1)

Step 1 — Remove the battery cover

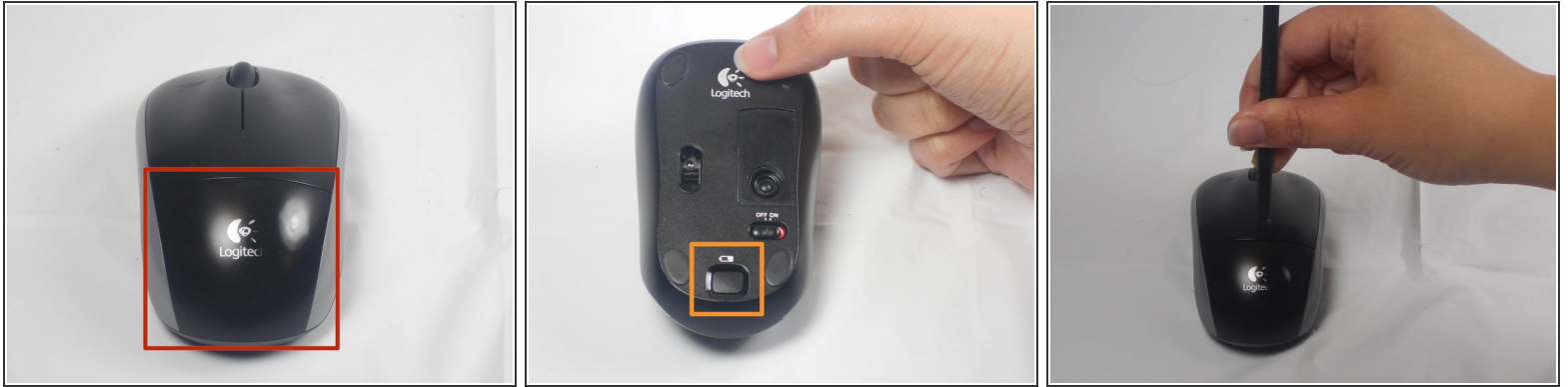

- The battery compartment cover is located on the top of the mouse. The seam running horizontally across the mouse is the top of the cover.
- There is a button to pop off the cover. It is located on the bottom of the mouse. you may need to press hard on this button to pop the cover.
- If the button does not work, you will need to pry off the cover. You can use your fingernails or a prying tool in order to do this, as seen in the third image.

Step 2 — Remove old battery



- Remember to insert the new battery in the same orientation as the old one. The positive (plus) end should be facing away from the buttons.

To reassemble your device, follow these instructions in reverse order.

This document was last generated on 2019-07-30 02:33:42 AM.