



iRobot Roomba 655 Pet Series Internal Faceplate Removal

How to remove your inner faceplate in order to access your control hub and motherboard.

Written By: Rhett



INTRODUCTION

Make sure you don't lose any screws! This guide has you unscrewing in a lot of spots so be careful!

TOOLS:

- [Phillips #0 Screwdriver](#) (1)
 - [Phillips #1 Screwdriver](#) (1)
-

Step 1 — Front Face Plate



- Remove the dust bin by pushing on the button for the dust bin removal
- Pull the dust bin out

Step 2



- Pull up on the silver handle to release the top protectant plastic
- Remove the top plastic carefully

Step 3 — Front Bumper

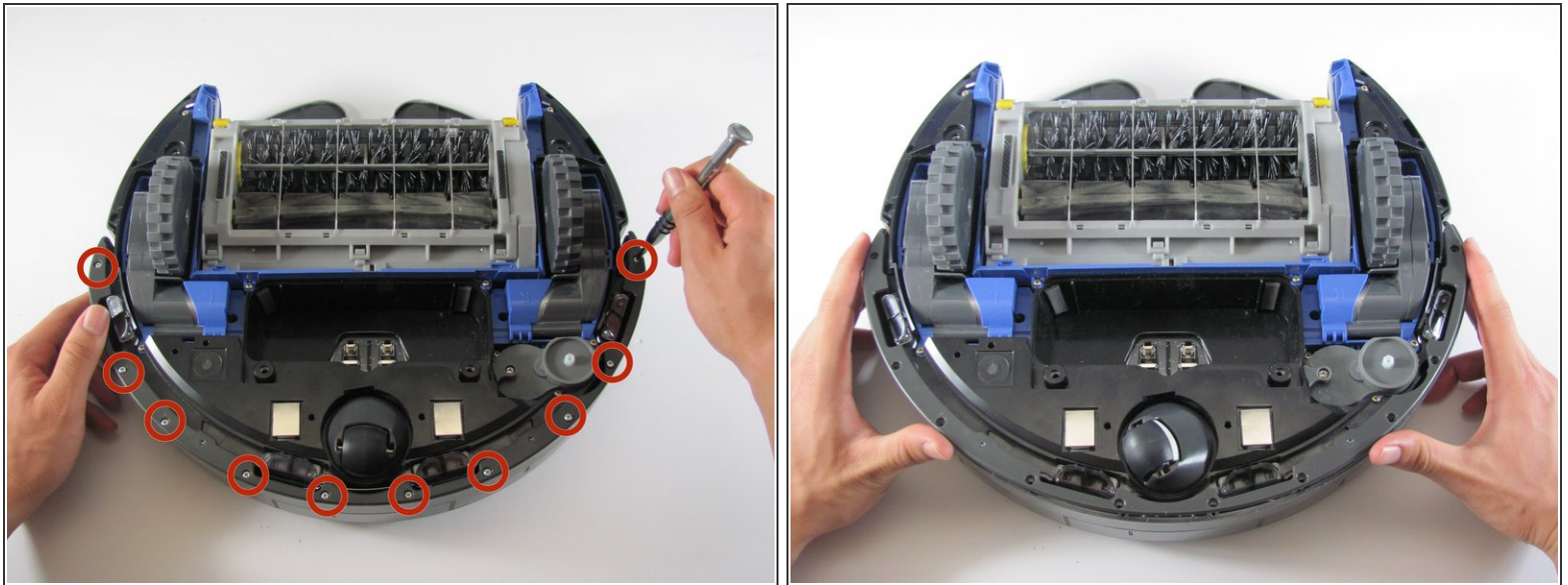

- Remove the ten 11mm screws that hold the front bumper to the plastic bumper protector with your Phillips #1 screwdriver.
- Pull the plastic bumper protector up and off of the bumper.

Step 4



- Flip the Roomba back over, so you are viewing the top.
- Pull up on the front bumper to remove it.
- ⚠ Be careful not to pull too hard because there is wiring attached to the bumper.
- Remove the two 7mm screws with your Phillips #1 screwdriver, holding the wire sensors in place to the front bumper.

Step 5 — Internal Faceplate



- The outside six - 10mm screws and the inside set of four - 10mm screws are the same here, use your Phillips head #2 to remove them
- Use your Phillips head #0 to remove the one - 7mm bottom center screw
- Use your Phillips head #2 to remove the two - 8mm screws by the handle
- Push down the two release points to pull the plastic piece up
- Pull the plastic piece up

To reassemble your device, follow these instructions in reverse order.