



Olympus VR-350 LCD Screen Replacement

Replace your LCD screen.

Written By: Chloe



INTRODUCTION

This guide will help you replace your LCD screen.

TOOLS:

- [Phillips #000 Screwdriver](#) (1)
 - [iFixit Opening Tools](#) (1)
-

Step 1 — Front Plate

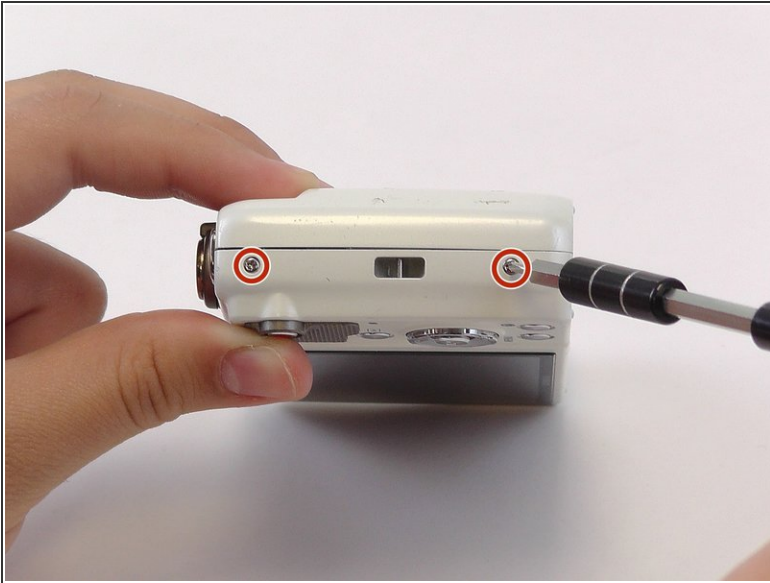

- Remove the two 4mm screws from each side of the camera with a Phillips PH000 screwdriver.

Step 2

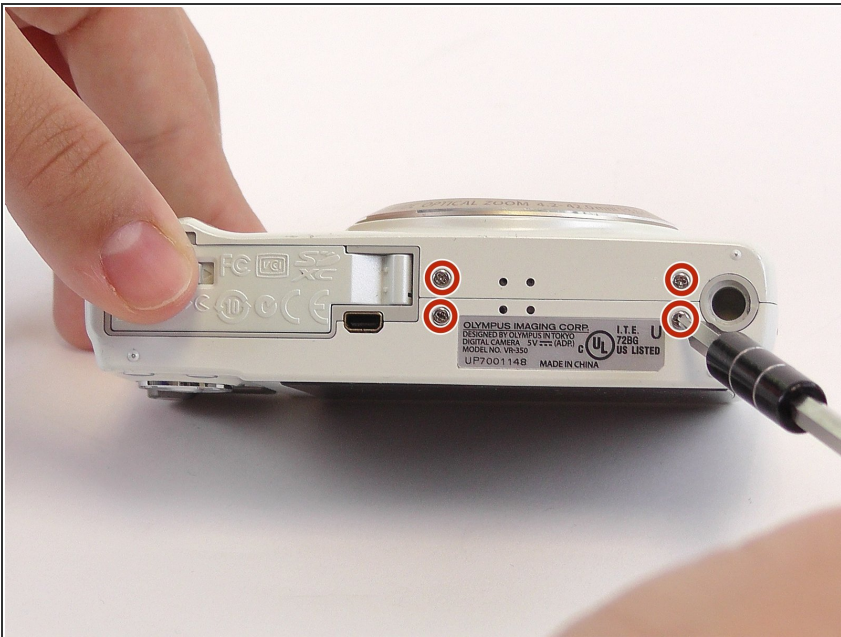

- Remove the four 4mm screws from the bottom of the camera with a Phillips PH000 screwdriver.

Step 3

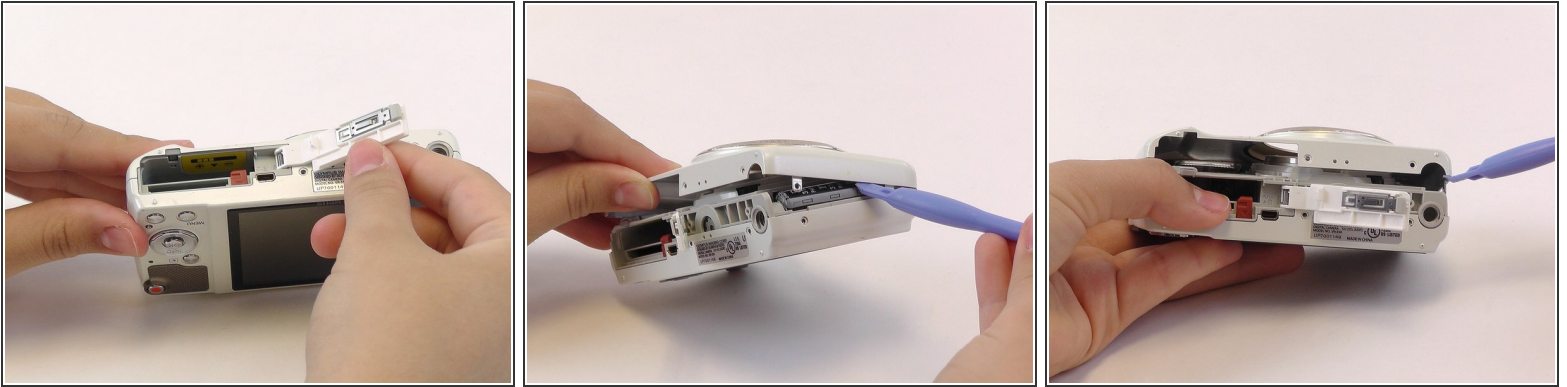

- Use the plastic opening tools and your fingers to pry the front plate from the camera.
- ⓘ You might need to open the battery cover to remove the front plate.

Step 4 — Back Plate



- Use your fingers to pry open the back cover.
- ⚠ When you remove the back of the camera, the button membrane might fall out. Don't lose this sheet.
- ⚠ The LCD screen is connected to the body of the camera by an orange ribbon cable. Don't pull this ribbon cable out.

Step 5 — LCD Screen

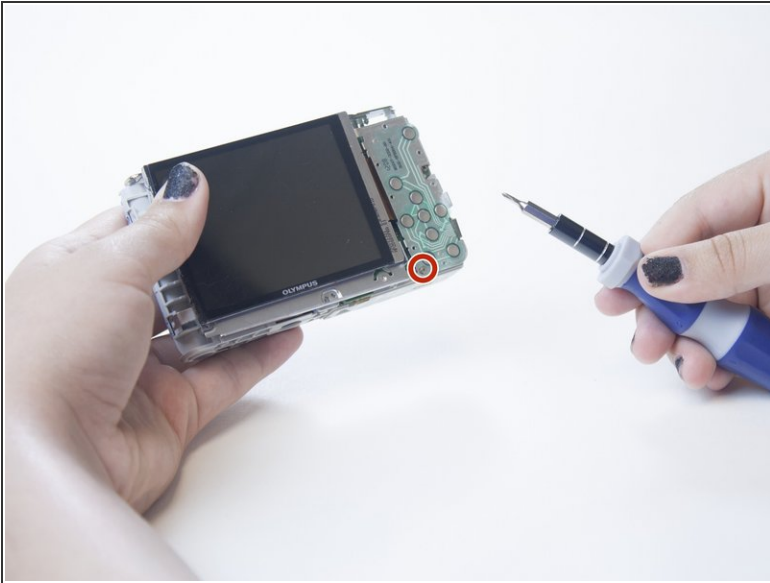

- Using the Phillips PH000 screwdriver, remove the 4mm screw from the bottom left corner of the button plate located under the button membrane.

Step 6



- Pull the button pad up to fully reveal the visible ribbon cable.
- ⓘ You might need to bend the button pad out of the way.

Step 7



- Pull out the LCD screen and the ribbon cable.
- ⓘ The ribbon cable should be easy to pull out.

To reassemble your device, follow these instructions in reverse order.