

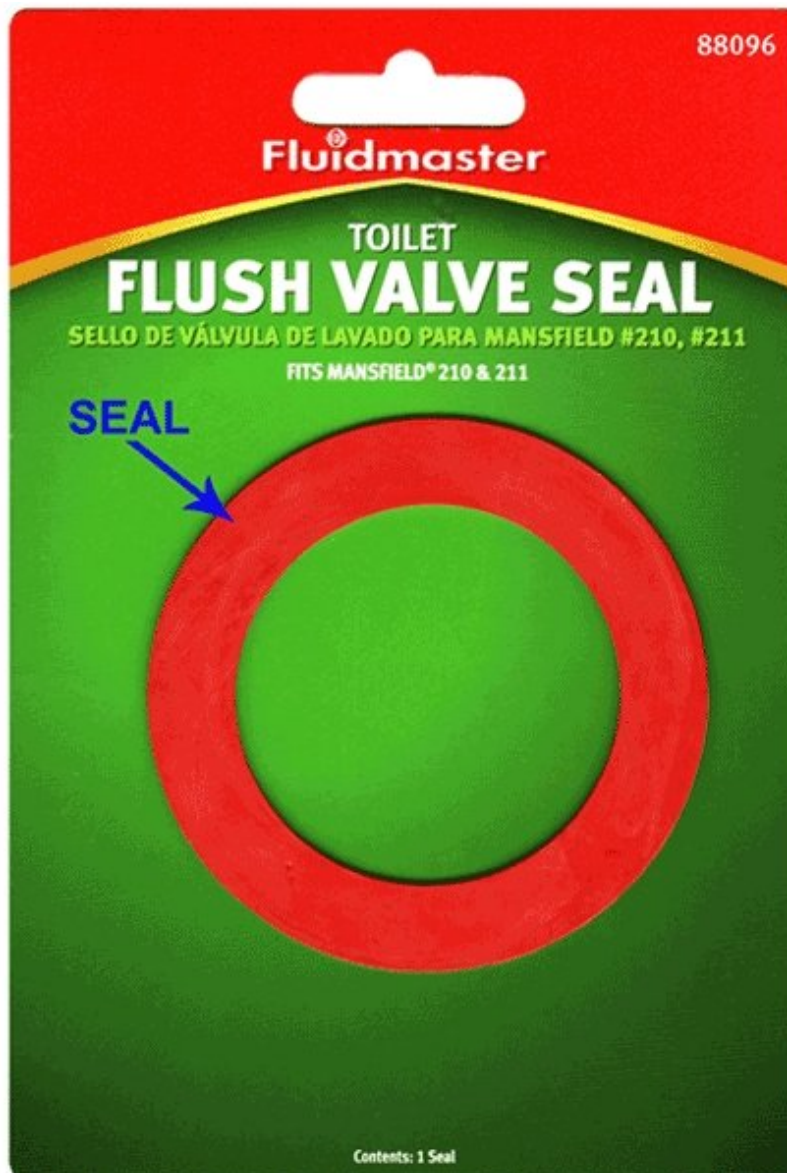

Toilet Flush Valve Seal Replacement

This guide is specific to a Flushmaster brand (Flushmaster, Inc.) toilet Flush Valve Seal that fits Mansfield(R) 210 & 211 Flush Valves. However, the shortcut method may also be applied to many other brands of toilet flush valves.

Written By: M J McAllister



INTRODUCTION

This is a **shortcut, time/labor-saving, method** of installing a replacement "flush valve seal" to stop water inside the toilet tank from seeping/leaking down the drain (and the continuous, *annoying* sound that accompanies this water loss).



PARTS:

- [Mansfield Toilet Flush Valve Seal](#) (1)
 - [American Standard Flush Valve Seal](#) (1)
-

Step 1 — Flush Valve Seal

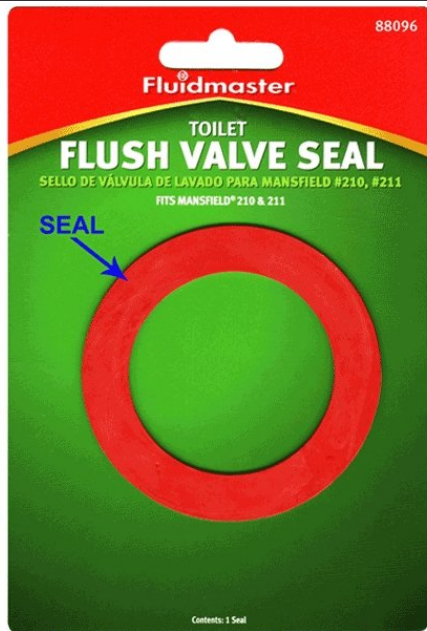

- i This is the New Valve Seal used in this guide, available at hardware stores and home centers.
- i Using this New Seal **installation shortcut method**, it will NOT be necessary to do the following (of the original instructions that accompany the New Seal product): "Turn off water supply to toilet and drain tank" and "Unhook trip lever..." [any "chain" will need to be momentarily unhooked.] and "Unthread stop cap..." and "Lift float assembly off....."

Step 2

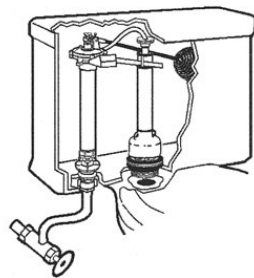
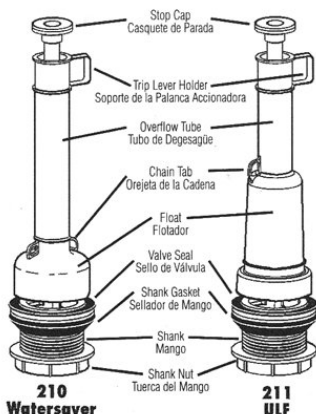

Manufactured for Fluidmaster, Inc.
by Danco © 2010 Irving, TX 75062
For customer service or product information
call Danco toll free: 1-800-523-5135 or go to
www.danco.com
Fluidmaster, Inc. © 2008
Fluidmaster, Inc.®

- Remove the top of the toilet tank.
- With a towel nearby, roll-up your sleeves. Flush the toilet to lower the tank water level.
- Immediately identify the old, worn [red] Valve Seal at bottom of the vertical assembly of Overflow Tube and Float.
- Reach into water tank and remove the worn valve seal by pulling it, like an old rubber band, with your finger tips (or pliers) until it breaks.

Step 3



- Roll the new seal and stick it through the square trip lever holder and lasso the free end of the trip lever (the opposite end of the lever is attached to the flush lever outside of the tank).
- Keeping the trip lever through large center hole of the new seal, pull the new seal in the reverse direction back through the square trip lever holder. Turn the trip lever holder as you do this to allow more space to ease the new seal back through.

Step 4

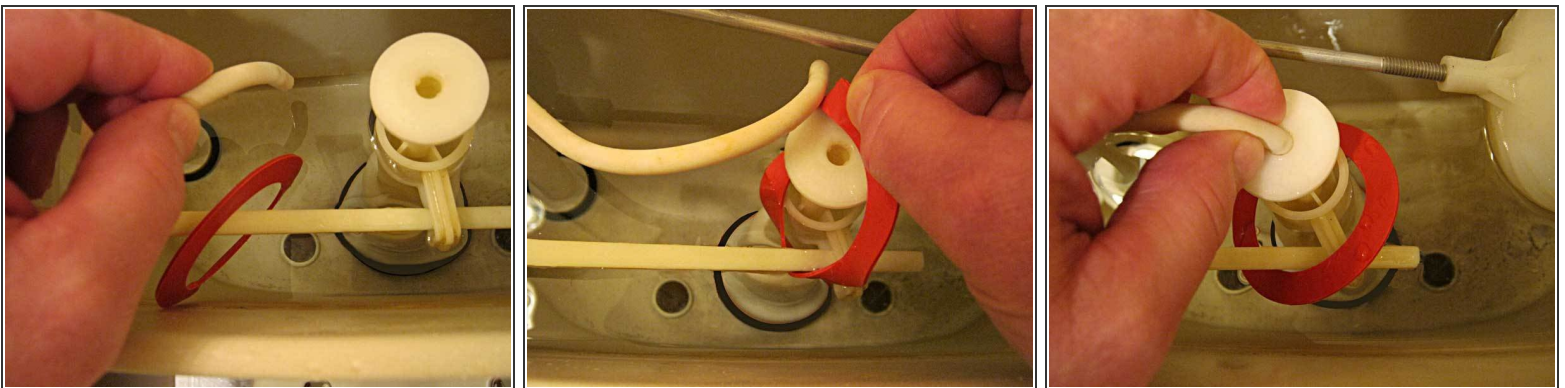

- When the new seal is between where the trip lever is connected to tank and where trip lever protrudes through square trip lever holder, for a moment, pull the flexible water refill tube out of the center of the stop cap. Point the free end of it down, as water may still be coming through it after flushing.
- Take the new seal just over the stop cap and replace the water refill tube, being careful not to splash any water coming out of it.

Step 5



- Gently stretch and pull the new seal all the way down the vertical assembly of the overflow tube and float near the bottom and position it into its top groove of the flush valve.
- Once in place, you should be able to gently grasp the edge of the new seal and turn it in place in the groove, around the base of the flush valve. Check the seal by flushing, watching and listening.

Step 6

Instructions:

1. Turn off water supply to toilet and drain tank. Unhook trip lever and chain connection. Remove refill tube from stop cap. Unthread stop cap located on the top of flush valve and remove.
2. Lift float assembly off of center guide post.
3. Remove old seal and replace with new seal. Be sure seal is positioned in very top groove on flush valve.
4. Replace float assembly, trip lever and chain connections, stop cap and refill tube. Check flush valve action to be sure seal seats properly. Turn on water supply and fill tank.

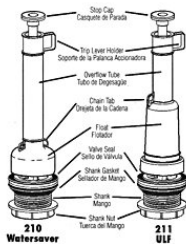

[Original instructions that accompany the product]

Instrucciones:

1. Cierre el suministro del agua del inodoro y vacíe el tanque. Desenganche la palanca accionadora y la conexión de la cadena. Retire el tubo de relleno del casquete de parada. Desatornille el casquete de parada de la parte superior de la válvula de descarga y retíelo.
2. Levante montaje del flotador del centro de la patilla guía.
3. Retire el sello viejo y reemplácelo con el sello nuevo. Asegúrese de que el sello esté colocado en la ranura superior en la válvula de descarga.
4. Reemplace el montaje del flotador, palanca accionadora, conexiones de cadena, casquete de parada y tubo de relleno. Revise el funcionamiento de la válvula de descarga para asegurarse de que el sello esté colocado correctamente. Abra el suministro de agua y llene el tanque.

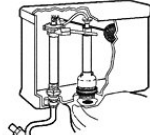

Manufactured for Fluidmaster, Inc.
by Danco © 2010 Irving, TX 75062
For customer service or product information
call Danco toll free: 1-800-523-5135 or go to
www.danco.com

Red-Green color arrangement is a registered
trademark of Fluidmaster, Inc. © 2008.
Fluidmaster, Inc. ®
registered trademark of Fluidmaster, Inc.
Made in China/Hecho en China
88009

- This is the *reverse side* of the Flush Valve Seal package.

Flush Valve Seals will need to be replaced, at least, once every few years, depending on water condition. Other kinds of toilet water tanks may have similar assemblies. Why call a plumber for something so easy to do yourself?!