



# why! N240JU battery replacement

Written By: Felice Suglia





## PARTS:

- [New Item](#) (1)
  - [New Item](#) (1)
  - [New Item](#) (1)
  - [New Item](#) (1)
-

## Step 1 — Battery

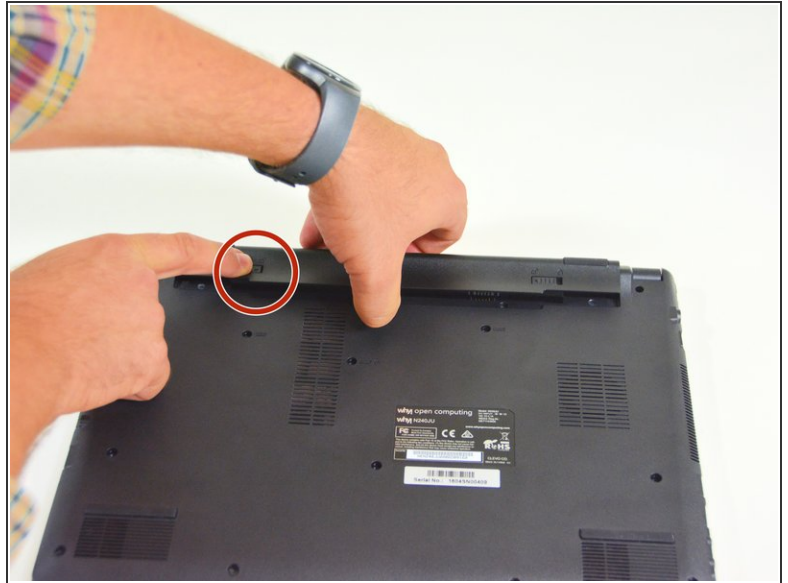

- Start by unlocking the right locking latch.
- Then, by simultaneously unlocking the left latch, lift the battery out of its socket.

To reassemble your device, follow these instructions in reverse order.

This document was last generated on 2019-01-15 05:45:32 AM.